

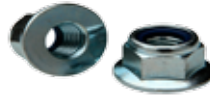

Bolts



Nuts



Part Number	Type	L	Diameter mm	Quality class
1831045	FH M	45	16	10.9
1831050	FH M	50	16	10.9
1831055	FH M	55	16	10.9
1831065	FH M	65	16	10.9
1831155	FH M	55	20	10.9
1831160	FH M	60	20	10.9
1831165	FH M	65	20	10.9
1831170	FH M	70	20	10.9
1831175	FH M	75	20	10.9
1831260	FH M	60	24	10.9
1831265	FH M	65	24	10.9
1831270	FH M	70	24	10.9
1831280	FH M	80	24	10.9
1821395	FH UNC	95	1 1/4"	*) , **)
1821300	FH UNC	100	1 1/4"	*)

Part Number	Ref No	Dimension/Type/Length
1821163	5J4773	FH 3/4" -63
1821157	4F7827	FH 3/4" -58
1821176	1J6762	FH 3/4" -76
1821189	2J2548	FH 3/4" -89
1821276	4F4042	FH 1" -76
1821282	4J9058	FH 1" -82
1821289	4J9208	FH 1" -89
1821200	5P8136	FH 1" -100
1821300	5P8823	FH 1 1/4" -100
1821395		FH 1 1/4" - 95 **)

Part Number	Type		Diameter mm	Quality class
1841001	Flange, nyloc		M 16	8.8
1841005	Flange	Phos.	M 16	10.9
1841002	Flange		M 20	10.9
1841004	Locknut	Phos.	M 24	10.9
1840002	Standard		M 16	8.8
1840003	Standard		M 20	8.8
1843001	Standard	Phos.	M 24	10.9
1840103	Standard		1 1/4"	***)

Part Number	Ref No	Dimension
1840101	2J3506	3/4"
1840102	2J3507	1"
1840103	3K9770	1 1/4"

*) Replaced 1840004
 **) Fully threaded
 ***) Quality class according to Caterpillar's standard.

Bolts and nuts are sold in packages of 25 pcs, except for 1 1/4" which are sold in packages of 10 pcs.

May 2019